

6 MECHANISM SECTION

LUBRICATION POINTS

When the marked parts are replaced, apply the recommended lubricants or adhesive for better maintenance of the unit.

Mark	Kind of Lubricant	Availability	Part Number
○ ○ ○	Oil	Purchase from Local Supplier	-----
△ △ △	Grease	Availability from Factory	VFKS0081

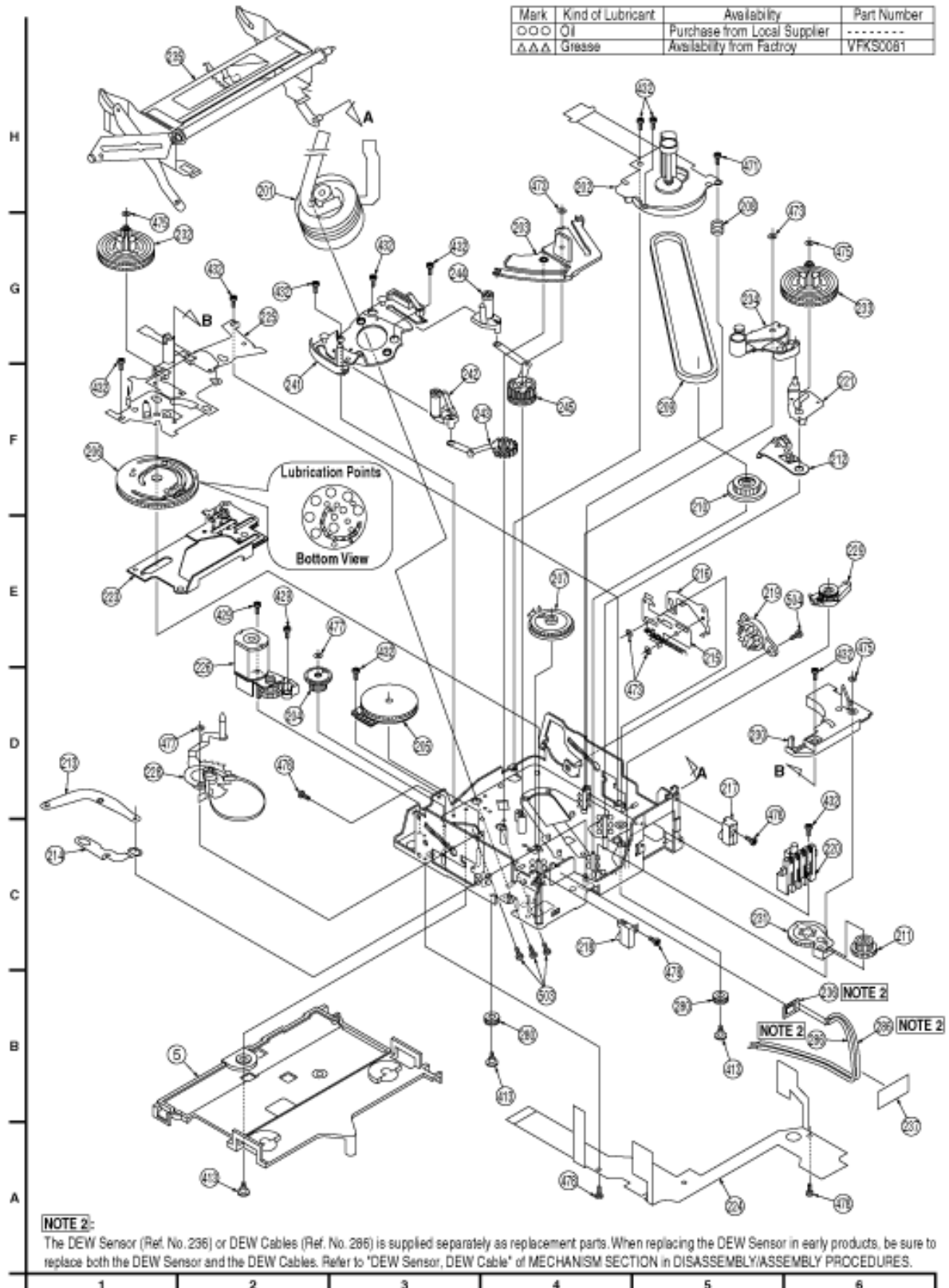

NOTE 2:

The DEW Sensor (Ref. No. 236) or DEW Cables (Ref. No. 286) is supplied separately as replacement parts. When replacing the DEW Sensor in early products, be sure to replace both the DEW Sensor and the DEW Cables. Refer to "DEW Sensor, DEW Cable" of MECHANISM SECTION in DISASSEMBLY/ASSEMBLY PROCEDURES.